

SOLID ZONE MIDBAY EMERGENCY LIGHT Y3653WA

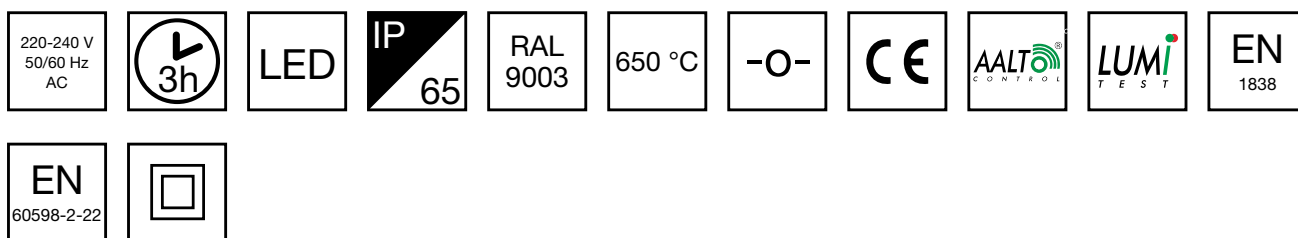

Self-contained 3 h Battery, Aalto Control compatible, emergency light for open areas (Individually packed TWT3653WA)

Solid Zone Midbay is developed for the emergency lighting of open areas.

High enclosure class (IP65) ensures that the luminaire is completely dust proof and water proof.

Solid is suitable for example for industrial premises and parking halls. Escap and centrally supplied luminaires are also suitable for outdoor use. The Solid luminaire uses long lasting leds as its light source.

Special attention has been paid to the design, for easy installation.

| | |
|-------------------------------------|---------------------------|
| Product Code | Y3653WA |
| Feature | Aalto Control, Lumi Test |
| Mounting (standard) | surface |
| Customs Code | 94056080 |
| GTIN Code | 6438045021782 |
| ETIM Product Class | EC001957 |
| Length | 371 mm |
| Width | 181 mm |
| Height | 57 mm |
| Weight | 1,1 kg |
| Backup | 3 h |
| Max Input Power VA | 4,1 VA |
| Nominal Supply Voltage | 220-240 V, 50/60 Hz AC |
| Protection Class | II |
| IP Class | IP65 |
| Temperature Range Min - Max | -0...+35 °C |
| Glow Wire Test of Plastic Materials | 650 °C |
| Light Source | LED |
| Body Material | plastic |
| Colour | RAL9003 |
| Electrical Installation | 2/3 x 2,5 mm ² |
| Luminous Flux | 600 lm |

Emergency lighting for open areas (ceiling mounting)

Table of 0,5 lux for open areas according to the norm EN 1838, 0,5 m edge district is considered in the table.

Level of measurement 0,02 m, measurement result with battery operation.



- R1 distance from wall (X axis)
- R2 installation distance between lights (X axis)
- R3 installation distance between lights (Y axis)
- R4 distance from wall (Y axis)

Y3653WA

| Mounting height (m) | Below the light lux | R1 (m) | R2 (m) | R3 (m) | R4 (m) |
|---------------------|---------------------|---------|---------|---------|---------|
| | | 0,5 lux | 0,5 lux | 0,5 lux | 0,5 lux |
| 4 | 35 | 5,5 | 10 | 10 | 5,5 |
| 6 | 15 | 6,5 | 12,5 | 12,5 | 6,5 |
| 8 | 8 | 7,5 | 14,5 | 14,5 | 7,5 |
| 10 | 5 | 7,5 | 15 | 15 | 7,5 |
| 12 | 3,5 | 8 | 16 | 16 | 8 |
| 14 | 2,5 | 8,5 | 17 | 17 | 8,5 |
| 16 | 2 | 8,5 | 18 | 18 | 8,5 |
| 18 | 1,5 | 8,5 | 17,5 | 17,5 | 8,5 |

OPTIONAL ACCESSORIES:

OPTIONAL MOUNTING ACCESSORIES FOR EMERGENCY EXIT LIGHTS



| Product Code | Product Name | Compatible Product Groups |
|--------------|-------------------------------------|--|
| TWT3006 | Solid Suspension Bracket TWT3006 | Solid Exit 2 Emergency Exit Lights, Solid: Line Lowbay Emergency Lights, Solid: Line Midbay Emergency Lights, Solid: Zone Lowbay Emergency Lights, Solid: Zone Midbay Emergency Lights |
| TWT3001 | Solid Recess Mounting Frame TWT3001 | Solid Exit Emergency Exit Lights, Solid Exit 2 Emergency Exit Lights, Solid: Line Lowbay Emergency Lights, Solid: Line Midbay Emergency Lights, Solid: Zone Lowbay Emergency Lights, Solid: Zone Midbay Emergency Lights |

We reserve the rights to make modifications without notice.
 Copyright © 2024 Teknoware. All rights reserved.
 Date: May 17, 2024 | Source:
www.teknoware.fi/en/solid-zone-midbay-emergency-light-y3653wa



Teknoware Oy | P.O. Box 19, 15101 Lahti | Ilmarisentie 8, 15200 Lahti Finland
 Tel +358 3 883 020 | VAT-number FI01494751 | teknoware.com | emexit@teknoware.com

| Product Code | Product Name | Compatible Product Groups |
|--------------|----------------------------------|--|
| TWT3002 | Solid Wall bracket TWT3002 | Solid Exit Emergency Exit Lights, Solid Exit 2 Emergency Exit Lights, Solid: Line Lowbay Emergency Lights, Solid: Line Midbay Emergency Lights, Solid: Zone Lowbay Emergency Lights, Solid: Zone Midbay Emergency Lights |
| TWT3003 | Solid Flag bracket TWT3003 | Solid Exit Emergency Exit Lights, Solid Exit 2 Emergency Exit Lights, Solid: Line Lowbay Emergency Lights, Solid: Line Midbay Emergency Lights, Solid: Zone Lowbay Emergency Lights, Solid: Zone Midbay Emergency Lights |
| TWT3004 | Solid Ceiling bracket TWT3004 | Solid Exit Emergency Exit Lights, Solid Exit 2 Emergency Exit Lights, Solid: Line Lowbay Emergency Lights, Solid: Line Midbay Emergency Lights, Solid: Zone Lowbay Emergency Lights, Solid: Zone Midbay Emergency Lights |

OTHER ACCESSORIES FOR EMERGENCY EXIT LIGHTS



| Product Code | Product Name | Compatible Product Groups |
|--------------|-------------------|--|
| TWT3007 | Solid lid TWT3007 | Solid: Line Lowbay Emergency Lights, Solid: Line Midbay Emergency Lights, Solid: Zone Lowbay Emergency Lights, Solid: Zone Midbay Emergency Lights |

COMPATIBLE PRODUCTS:

OPTIONAL MOUNTING ACCESSORIES FOR EMERGENCY EXIT LIGHTS



| Product Code | Product Name | Compatible Product Groups |
|--------------|-------------------------------------|--|
| TWT3006 | Solid Suspension Bracket TWT3006 | Solid Exit 2 Emergency Exit Lights, Solid: Line Lowbay Emergency Lights, Solid: Line Midbay Emergency Lights, Solid: Zone Lowbay Emergency Lights, Solid: Zone Midbay Emergency Lights |
| TWT3001 | Solid Recess Mounting Frame TWT3001 | Solid Exit Emergency Exit Lights, Solid Exit 2 Emergency Exit Lights, Solid: Line Lowbay Emergency Lights, Solid: Line Midbay Emergency Lights, Solid: Zone Lowbay Emergency Lights, Solid: Zone Midbay Emergency Lights |
| TWT3002 | Solid Wall bracket TWT3002 | Solid Exit Emergency Exit Lights, Solid Exit 2 Emergency Exit Lights, Solid: Line Lowbay Emergency Lights, Solid: Line Midbay Emergency Lights, Solid: Zone Lowbay Emergency Lights, Solid: Zone Midbay Emergency Lights |
| TWT3003 | Solid Flag bracket TWT3003 | Solid Exit Emergency Exit Lights, Solid Exit 2 Emergency Exit Lights, Solid: Line Lowbay Emergency Lights, Solid: Line Midbay Emergency Lights, Solid: Zone Lowbay Emergency Lights, Solid: Zone Midbay Emergency Lights |
| TWT3004 | Solid Ceiling bracket TWT3004 | Solid Exit Emergency Exit Lights, Solid Exit 2 Emergency Exit Lights, Solid: Line Lowbay Emergency Lights, Solid: Line Midbay Emergency Lights, Solid: Zone Lowbay Emergency Lights, Solid: Zone Midbay Emergency Lights |

We reserve the rights to make modifications without notice.
 Copyright © 2024 Teknoware. All rights reserved.
 Date: May 17, 2024 | Source:
www.teknoware.fi/en/solid-zone-midbay-emergency-light-y3653wa

Teknoware Oy | P.O. Box 19, 15101 Lahti | Ilmarisentie 8, 15200 Lahti Finland
 Tel +358 3 883 020 | VAT-number FI01494751 | teknoware.com | emexit@teknoware.com



OTHER ACCESSORIES FOR EMERGENCY EXIT LIGHTS



| Product Code | Product Name | Compatible Product Groups |
|--------------|-------------------|--|
| TWT3007 | Solid lid TWT3007 | Solid: Line Lowbay Emergency Lights, Solid: Line Midbay Emergency Lights, Solid: Zone Lowbay Emergency Llghts, Solid: Zone Midbay Emergency Lights |



We reserve the rights to make modifications without notice.
Copyright © 2024 Teknoware. All rights reserved.
Date: May 17, 2024 | Source:
www.teknoware.fi/en/solid-zone-midbay-emergency-light-y3653wa

Teknoware Oy | P.O. Box 19, 15101 Lahti | Ilmarisentie 8, 15200 Lahti Finland
Tel +358 3 883 020 | VAT-number FI01494751 | teknoware.com | emexit@teknoware.com



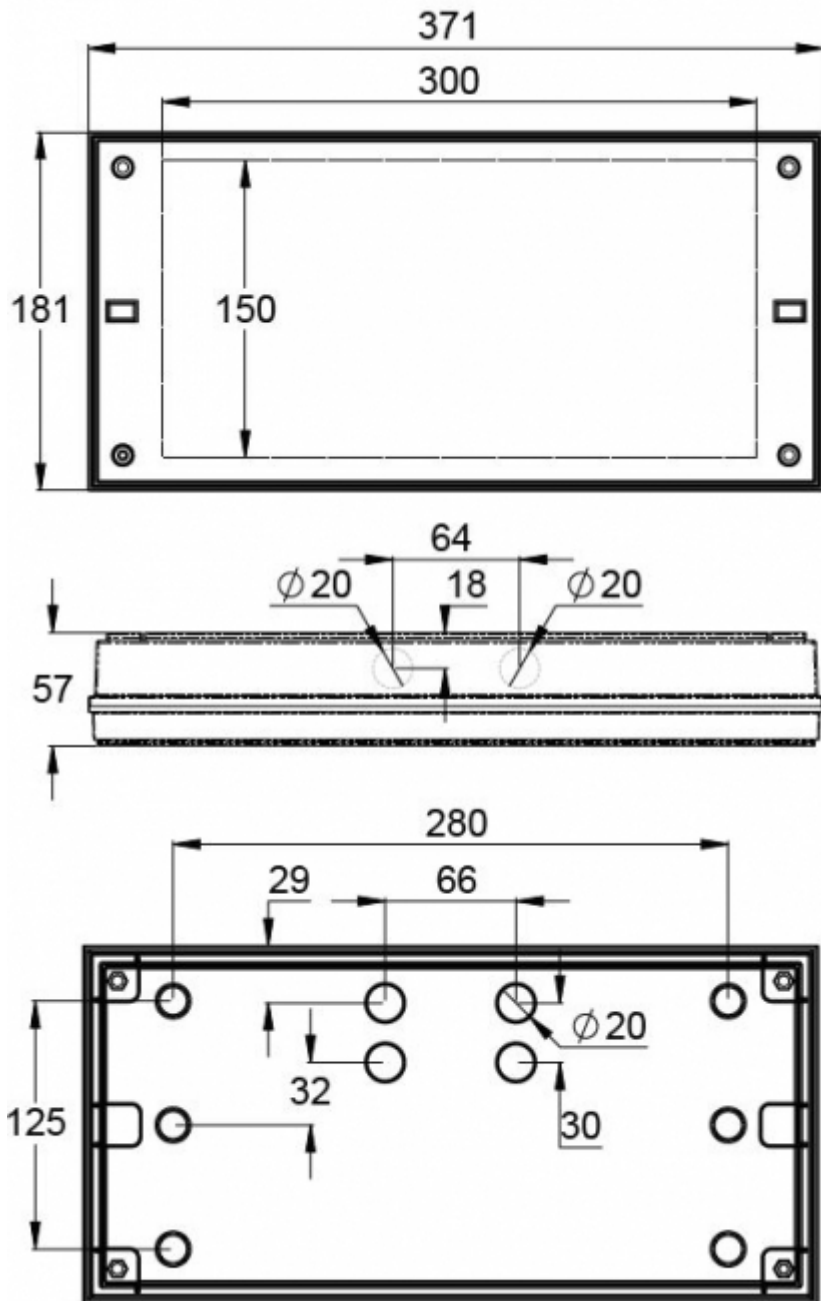

We reserve the rights to make modifications without notice.
 Copyright © 2024 Teknoware. All rights reserved.
 Date: May 17, 2024 | Source:
www.teknoware.fi/en/solid-zone-midbay-emergency-light-y3653wa

Teknoware Oy | P.O. Box 19, 15101 Lahti | Ilmarisentie 8, 15200 Lahti Finland
 Tel +358 3 883 020 | VAT-number FI01494751 | teknoware.com | emexit@teknoware.com

